



Industrie Service

ZERTIFIKAT Certificate

EG-Baumusterprüfung (Modul B) nach Richtlinie 1999/36/EG und ADR/RID, 6.2.1.4
EC-type-examination (module B) according to Directive 1999/36/EC and ADR/RID, 6.2.1.4

Zertifikat-Nr.: **0036-038-04 Rev. 1**
Certificate No.:

Gültigkeit / Validity: 10 Jahre / 10 Years

Name und Anschrift des Antragstellers: Swagelok Company,
Name and Postal Address of Applicant: 29500 Solon Road, Solon, OH 44139; USA

Hiermit wird bescheinigt, daß das unten genannte EG-Baumuster die Anforderungen der Richtlinie 1999/36/EG erfüllt. / We herewith certify that the EC type specified below meets the requirements of the Directive 1999/36/EC.

Prüfbericht Nr.: P-USA-04-10-28-01des / of TÜV America Inc. Industry
Test Report No.: Service vom / dated Oct. 28th 2004 und / and
P-USA-06-02-28-001 Rev. 01 der / of TÜV SÜD
Industrie Service GmbH vom / dated 22. Juni 2006

Typ, Norm, Zeichnung, Revision, Datum
Type, Standard, Drawing, Revision, Date
Ventile nach / Valves according **EN 849**
SS-3N-TPED, Rev. A,
vom / dated 12/21/2004 (Anlage/Enclosure)

Fertigungsstätte / Manufacturing Plant
Swagelok OFC; 29495 F.A. Lennon Drive;
Solon, OH 44139, USA

(Ort, Datum)
(Location, Date)

München, 2006-09-07



TÜV SÜD Industrie Service GmbH
TÜV-CERT-Zertifizierungsstelle
für Druckgeräte

Klaus J. Meier
Benannte Stelle, Kennnummer 0036
Notified Body, identification number 0036

TÜV SÜD Industrie Service GmbH
Dampf- und Drucktechnik
Westendstraße 199
D-80686 München
Tel.: +49 (0) 89 / 5791-1891
Fax: +49 (0) 89 / 5791-1810
www.tuev-sued.de

Mitglied der
CONFÉDÉRATION EUROPÉENNE



D'ORGANISMES DE CONTROLE

ZERTIFIKAT ◆ CERTIFICATE ◆ 認 証 証 書 ◆ CERTIFICADO ◆ CERTIFIKAT ◆ CERTIFICAT

REVISIONS	
REV.	DCH
-	03-5210 04-17067
A	

DWG. NO. SS-3N-TPED

END CONNECTIONS	O.D.	I.D.
1/4" SWAGelok TUBE FITTING	0.370	0.257
3/8" SWAGelok TUBE FITTING	0.370	0.243
1/2" SWAGelok TUBE FITTING	0.435	0.322
1/4" MALE NPT	0.540	0.281
1/8" FEMALE NPT	0.688	0.342
1/4" FEMALE NPT	0.745	0.446

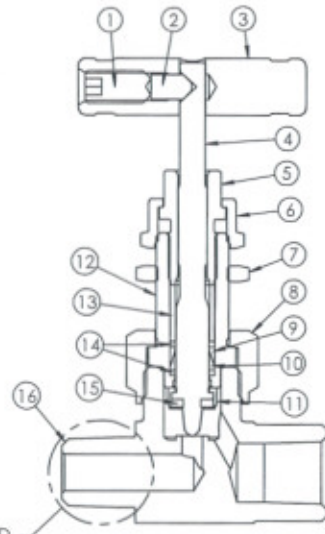

SEE DETAIL & TABLE FOR NOMINAL O.D. & I.D.

BILL OF MATERIAL				
ITEM	NAME	MATERIAL	DRAWING NUMBER	QTY
1	SET SCREW	S17400	174PH-6SS-0189-APPROVAL	1
2	HANDLE PIN	S17400	174PH-SB-14B-APPROVAL	1
3	HANDLE	SS 316	SS-S2-14B-APPROVAL	1
4	STEM SHANK	CHROME-PLATED SS 316	SS-3A-3NTR-APPROVAL	1
5	PACKING BOLT	NICKEL CADMIUM-PLATED SS 416	416-4A-3N-APPROVAL	1
6	LOCK NUT	SS 316	SS-11A-3N-APPROVAL	1
7	PANEL NUT	SS 316 POWDERED METAL	SS-7-2-APPROVAL	1
8	UNION NUT	SS 316	SS-11-3-APPROVAL	1
9	UPPER PACKING	PEEK	PK-8A-3N-APPROVAL	1
10	LOWER PACKING	PEEK	PK-8B-3N-APPROVAL	1
11	STEM TIP RETAINER	SS 316	SS-3C-3NTR-APPROVAL	1
12	BONNET	SS 316	SS-2-3N-APPROVAL	1
13	GLAND	SS 316	SS-8-3N-APPROVAL	1
14	PACKING SUPPORTS	PEEK	PK-6C-3N-1-APPROVAL	2
15	STEM TIP INSERT	PEEK	PK-3B-3NTR-APPROVAL	1
16	BODY	SS 316	SS-1-3TM4-F4-APPROVAL (STRAIGHT PATTERN)	1
		SS 316	SS-1-3TM4-F4-A-APPROVAL (ANGLE PATTERN)	1

SPECIFICATIONS:

ORIFICE: 4.0MM
 WORKING PRESSURE: 345 BAR
 HYDRAULIC TEST PRESSURE: 518 BAR
 TEMPERATURE RATING: -20°C TO 65°C

NOTES:
 1. STRAIGHT AND ANGLE PATTERN VALVES ARE AVAILABLE.
 2. OPTIONAL END FITTINGS THAT DO NOT DECREASE THE MINIMUM WALL THICKNESS ARE AVAILABLE.
 3. NOT APPROVED FOR USE WITH ACETYLENE OR GASSES WITH AN OXIDIZING POTENTIAL GREATER THAN AIR.
 4. VALVE MUST BE PROTECTED FROM IMPACT DURING TRANSPORT BY A CAP OR ANOTHER FORM OF GUARDING.

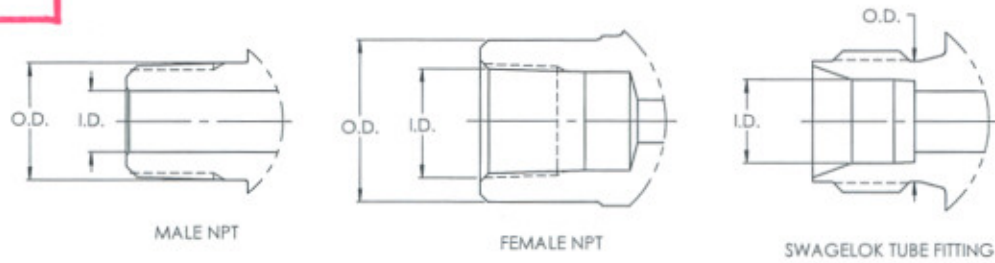

TÜV SÜD Industrie Service GmbH
 0036 — 0 3 8 — 0 4 Rev. 1
 Anlage 1/1 zum Zertifikat

THIS PRINT IS THE EXCLUSIVE PROPERTY OF SWAGelok COMPANY. IT MUST BE RETURNED ON REQUEST ALONG WITH ANY DOCUMENTS CONTAINING INFORMATION OBTAINED FROM THIS PRINT. NEITHER THIS PRINT NOR ANY PART OF IT NOR ANY INFORMATION CONCERNING IT MAY BE COPIED, DISCLOSED TO OTHERS OR USED FOR ANY PURPOSE EXCEPT IN FURTHERANCE OF YOUR BUSINESS WITH SWAGelok. THE PARTS REFERRED TO ON THIS PRINT MAY BE THE SUBJECT OF PATENTS AND/OR PENDING APPLICATIONS AND MAY NOT BE MANUFACTURED WITHOUT PERMISSION FROM SWAGelok COMPANY.

TOLERANCE ON ENGLISH DIMENSIONS UNLESS OTHERWISE SPECIFIED
 .XX ±.031
 .XXX ±.015
 ANGLES ±1 DEGREE
 -- DIMENSIONS ARE INCHES NEXT TO [MILLIMETERS]

TITLE APPROVAL DRAWING	
DRAWN BY JTJ	DATE 9/2/2004
CHECK/APP BY JMK	DATE 12/21/2004

Swagelok

DWG. NO. SS-3N-TPED

SHEET 1 of 1
SCALE NONE
REV. A